



arian®
PUMP
Technology and quality

NL SERIES

END SUCTION CENTRIFUGAL PUMP

Uçtan Emişli Santrifüj Pompa

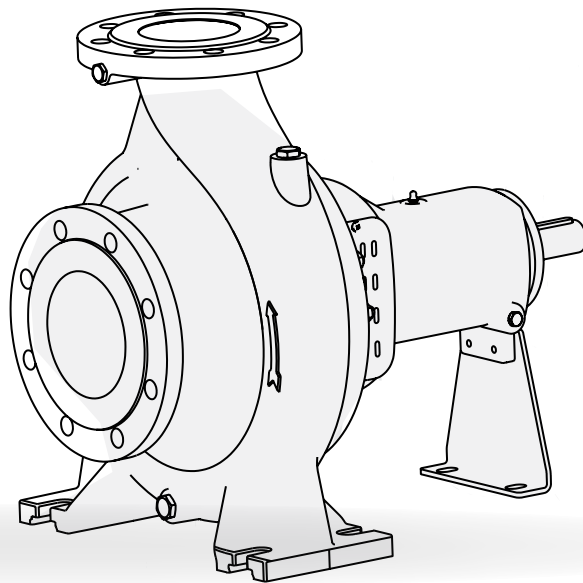

GENERAL INFORMATION

Discharge Flange	DN 32 - DN 250
Capacity	1700 m ³ /h
Head	100 m
Frequency	Three-phase 50 Hz - 60 Hz*
Temperature of Pumped Liquid	From -25 °C to +140 °C
Maximum Operating Pressure	10 bar (16 bar)*

Depending on the type of liquid, operating temperature and pressure. The pump material changes. Please contact our company for detailed information.

Transferable Liquids

- Clean or slightly dirty, non-abrasive, low-viscosity fluids.

Shaft Sealing

- Soft packing is used in standard production.
- It is possible to use mechanical seal according to customer request or type of liquid.

Applications

Water Treatment and Pressurization	Power Plants
Heating, Ventilating and Air Conditioning	Oil Industry
Agricultural Irrigation and Drainage	Chemical Industry
Food and Beverage Industry	Mining
Iron and Steel Industry	Marine
Building System	Fire Fighting

Design Features

- NL series pumps have designed for pumping non-abrasive and small particulars liquids.
- NL series pump has just one impeller, pump and motor is connecting by coupling. It gives your advantages for easy disassembling.
- Pump Dimensions are according to EN 733 - DIN 24255 standard.
- Suction and discharge flanges according to EN 1092-2 / PN 16.
- NL series have a closed impeller, impeller blades located between the balancing holes to minimize the axial load is taken in dynamic load balancing.
- Sealing is provided by gland packing. Sealing is provided by also mechanical seal as customer request.
- Easy disassembly to pump and change impeller, bearings, and seals.
- All impellers are statically and dynamically balanced according to ISO 1940 class 6.3.
- In addition to 29 models, 10 complementary models are designed in according to EN 733 standards. The main dimensions of complementary models may different from other manufacturers.
- Direction of rotation is clockwise viewed from the driver end.
- Optionally, pumps can be manufactured with shaft bushings and/or wear rings.

Pump Code

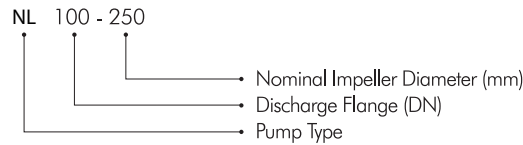

GENEL BİLGİLER

Basma Flaşı	DN 32 - DN 250
Debi	1700 m ³ /h
Basma Yüksekliği	100 m
Frekans	Üç Fazlı 50 Hz - 60 Hz*
Akışkan sıcaklığı	-25 °C den +140 °C'ye kadar
Maksimum Çalışma Basıncı	10 bar (16 bar)*

Basilan sıvının cinsine, çalışma sıcaklığı ve basıncına bağlı olarak pompa malzemesi değişir. Ayrıntılı bilgi için firmamıza başvurunuz.

Basılabilen Sıvılar

- Temiz veya çok hafif kirli, aşındırıcı olmayan, düşük viskoziteli sıvılar.

Mil Sızdırmazlığı

- Standart üretimde yumuşak salmastra kullanılmaktadır.
- Müşterinin isteğine veya sıvının cinsine göre mekanik salmastra kullanmak da mümkündür.

Kullanım Yerleri

Su Arıtımı ve Basınçlandırılması	Enerji Santralleri
Isıtma, Havalandırma ve İklimlendirme	Petrol Endüstrisi
Tarımsal Sulama ve Drenaj	Kimya Endüstrisi
Gıda ve İçecek Endüstrisi	Madencilik
Demir Çelik Endüstrisi	Denizcilik
Bina Sistemleri	Yangın Söndürme

Tasarım Özellikleri

- NL serisi aşındırıcı olmayan, büyük katı parçacıklar içermeyen sıvıları basmaya uygun tasarlanmıştır.
- Tek kademeli pompalardır ve motor ile bağlantısında kaplin kullanılması sayesinde gerektiğinde motoru veya pompayı yerinden oynatmadan ayılabileceği sunar.
- Salyangozun genel ölçüleri TS EN 733 - DIN 24255 standardına uygundur.
- Emme ve Basma flaşları TS EN 1092-2/PN 16 standardına uygundur.
- NL serisinde kapalı çark kullanılır ve bu çarkta eksenel yüklerin minimize edilmesi için kanatlar arasında dengeleme delikleri bulunur, dinamik yükler içinde balans alınmıştır.
- Mil sızdırmazlığında yumuşak salmastra kullanılır. Talebe göre mil sızdırmazlığını mekanik salmastra ile de sağlanabilir.
- Tasarımı sayesinde gerekli durumlarda çarkı rulmanlar ve salmastrası kolaylıkla değiştirilebilir.
- TS EN 733 standartlarına uygun 29 modele ek olarak 10 tamamlayıcı model tasarlanmıştır. Tamamlayıcı modellerin ana boyutları diğer üreticilere göre farklılık gösterebilir.
- Bütün çarklar ISO 1940 sınıf 6.3'e uygun olarak statik ve dinamik olarak dengelenmektedir.
- Pompa dönüş yönü; motor tarafından bakıldığında saat ibresi yönündedir.
- İsteğe bağlı olarak pompalar mil burçlu ve/veya aşınma halkalı imal edilebilir.

Pompa Kodu

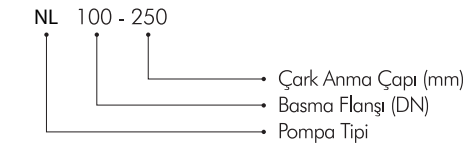

MATERIAL OPTIONS

Part List	0.6025	0.7040	1.7043	1.0619	1.4308	1.4309	1.4408	1.4409	1.4500	1.4517	1.4469	1.4317	1.4008	2.1050.01	2.1050.01	2.1096.01	1.0503	1.4021	1.4021+QT	1.4301	1.4404	1.4460	1.4462	Parça Listesi		
Volute Casing	●	○	○	○	○	○	○	○	○	○	○	○	○	○											Salyangoz Gövde	
Seal Box	●	○	○	○	○	○	○	○	○	○	○	○	○	○												Salmastra Kutusu
Impeller	●	○	○	○	○	○	○	○	○	○	○	○	○	○	○	○										Çark
Shaft																	○	●	○	○	○		○			Mil
Bearing Housing	●	○	○	○	○	○	○	○																		Rulman Yatağı
Wear Ring	○	○	○	○	○	○	○	○	○	○	○	○	○	○	○	○										Aşınma Halkası
Shaft Wear Bushing																	○	○	○	○	○		○			Mil Aşınma Burcu
Mech. Seal (*)	EN 12756 / DIN 24250														Mek. Salmastra (*)											

(*) Options: Different brand and type mechanical seal can be use can according to customer request.

(*) Seçenekler: Alıcının isteğine veya çalışma şartlarına bağlı olarak değişik tip ve markalarda mekanik salmastra kullanılabilir.

- Standard Manufacturing
- Optional

- Standart İmalat
- İsteğe Bağlı

DESCRIPTIONS

	DIN	EN	SAISI/SAE/ASTM	TANIM
Cast Iron	0.6025	EN-GJL-250 (GG 25)	A 48 Class 40-B	Pik Döküm
Ductile Iron Casting	0.7040	EN-GJS-400-18-LT (GGG 40)	A 536 60-40-18	Sfero Döküm
Ductile Iron Casting	0.7043	EN-GJS-400-18-LT (GGG 40.3)	A 536 60-40-18	Sfero Döküm
Steel Casting	1.0619	GP 240 GHGS-C25	A216 WCB	Çelik Döküm
Chrome Nickel Steel Casting	1.4308	G-X5 Cr Ni 19-10	A 351 CF8	Krom Nikelli Çelik Döküm
Chrome Nickel Steel Casting (Low Carbon)	1.4309	G-X2 Cr Ni 19-11	A 351 CF3	Krom Nikelli Çelik Döküm (D. K.)
Chrome Nickel Molybdenum Steel Casting	1.4408	G-X5 Cr Ni Mo 19-11-2	A 351 CF8M	Krom Nikel Molibdenli Çelik Döküm
Chrome Nickel Molybdenum Steel Casting (L.C.)	1.4409	G-X2 Cr Ni Mo 19-11-2	A 351 CF3M	Krom Nikel Molibdenli Çelik Döküm (D.K.)
Austenitic Steel Casting	1.4500	G-X7 Cr Ni Mo Cu N 25-6-3-3	A 351 CN7M	Östenitik Çelik Döküm
Austenitic - Ferritic Steel Casting (Duplex)	1.4517	G-X2 Cr Ni Mo Cu N 25-6-3-3	A 890 CD4MCuN	Östenitik-ferritik Çelik Döküm (D.)
Austenitic - Ferritic Steel Casting (S.D.)	1.4469	G-X2 Cr Ni Mo N 26-7-4	A 890 CE3MN	Östenitik-ferritik Çelik Döküm (S.D.)
Martensitic Stainless Steel Casting	1.4317	G-X4 Cr Ni 13-4	A 352 CA6NM	Martenzitik Paslanmaz Çelik Döküm
Martensitic Stainless Steel Casting	1.4008	G-X7 Cr Ni Mo 12-1	A 217 CA15	Martenzitik Paslanmaz Çelik Döküm
Bronze Casting (Tinned)	2.1050.01	G-Cu Sn 10	B 427 C90700	Bronz Döküm (Kalaylı)
Bronze Casting (Nickel Alloy)	2.0975.01	G-Cu Al10 Ni	B 148 C95500	Bronz Döküm (Nikel Alaşımli)
Bronze Casting (Leaded)	2.1096.01	G-Cu Sn 5 Zn Pb	B 584 C83600	Bronz Döküm (Kurşunlu)
Carbon Steel	1.0503	C 45	SAISI 1045	Karbonlu Çelik
Chromium Steel	1.4021	X20 Cr13	A 276 Type 420	Kromlu Çelik
Chrome Steel (Heat Treatment)	1.4021	X20 Cr13	A 276 Type 420+QT	Krom Nikel Çelik (Isıl İşlem)
Chrome Nickel Steel	1.4301	X5 Cr Ni 18-10	A 276 Type 304	Krom Nikel Çelik
Chrome Nickel Molybdenum Steel (L.C.)	1.4404	X2 Cr Ni Mo 17-12-2	A 276 Type 316L	Krom Nikel Molibdenli Çelik (D.K.)
Duplex (Austenitic-Ferritic) Steel	1.4460	X3 Cr Ni Mo N 27-5-2	SAISI 329	Dubleks (Östenitik-Ferritik) Çelik
Duplex (Austenitic-Ferritic) Steel	1.4462	X2 Cr Ni Mo N 22-5-3	UNS S32205	Dubleks (Östenitik-Ferritik) Çelik

MALZEME SEÇENEKLERİ

1450 rpm / (d/d) (50 Hz)

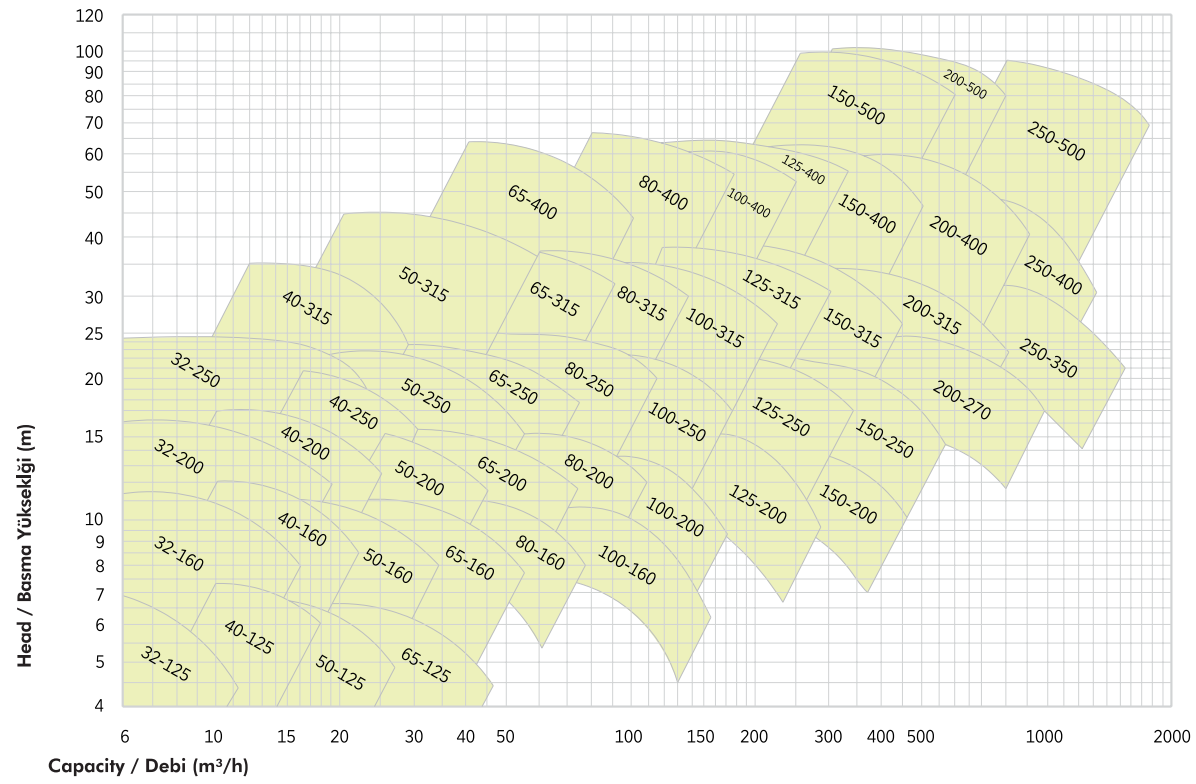

1750 rpm / (d/d) (60 Hz)

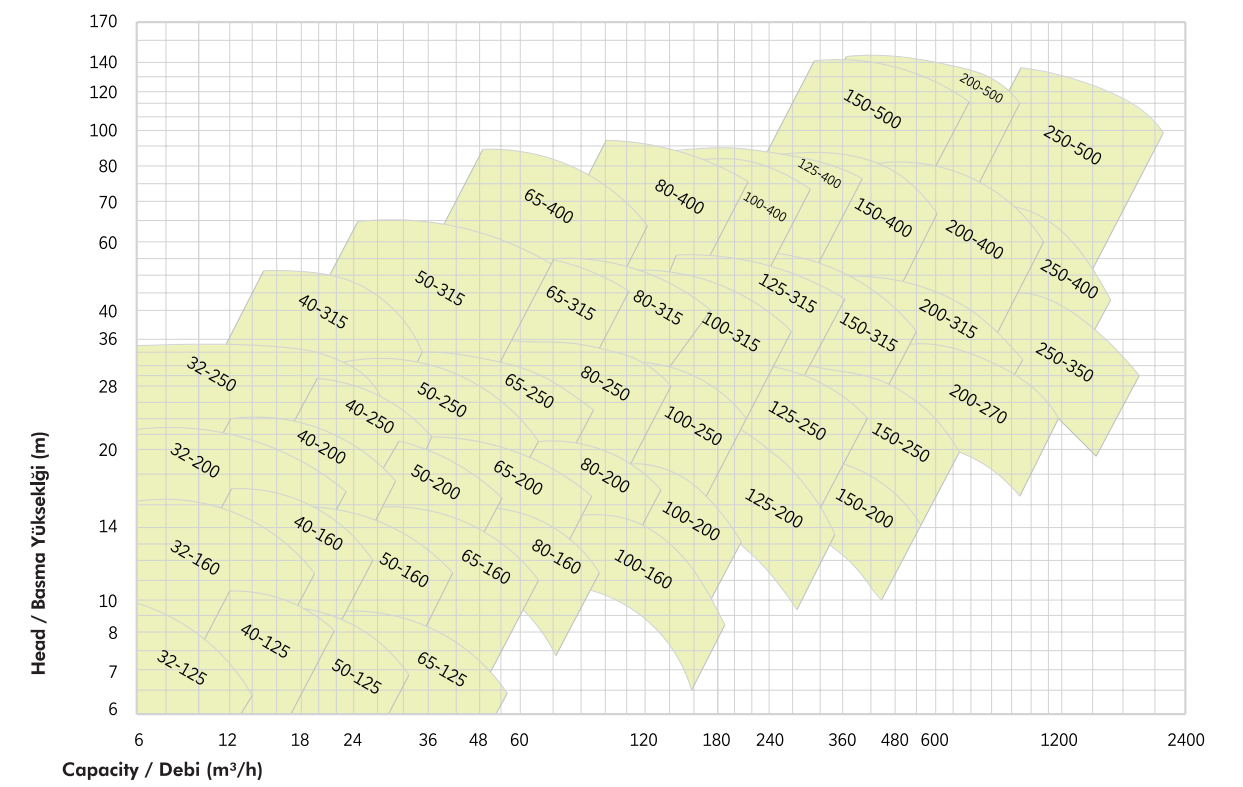

2900 rpm / (d/d) (50 Hz)

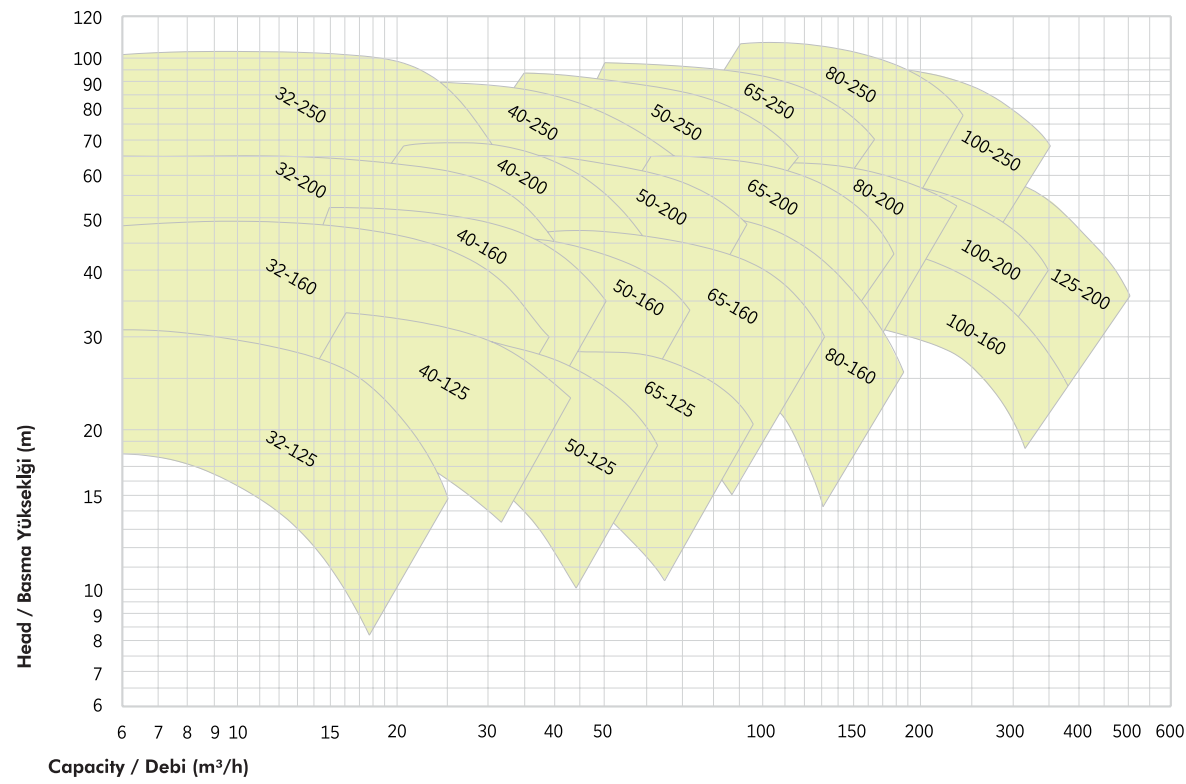

3500 rpm / (d/d) (60 Hz)

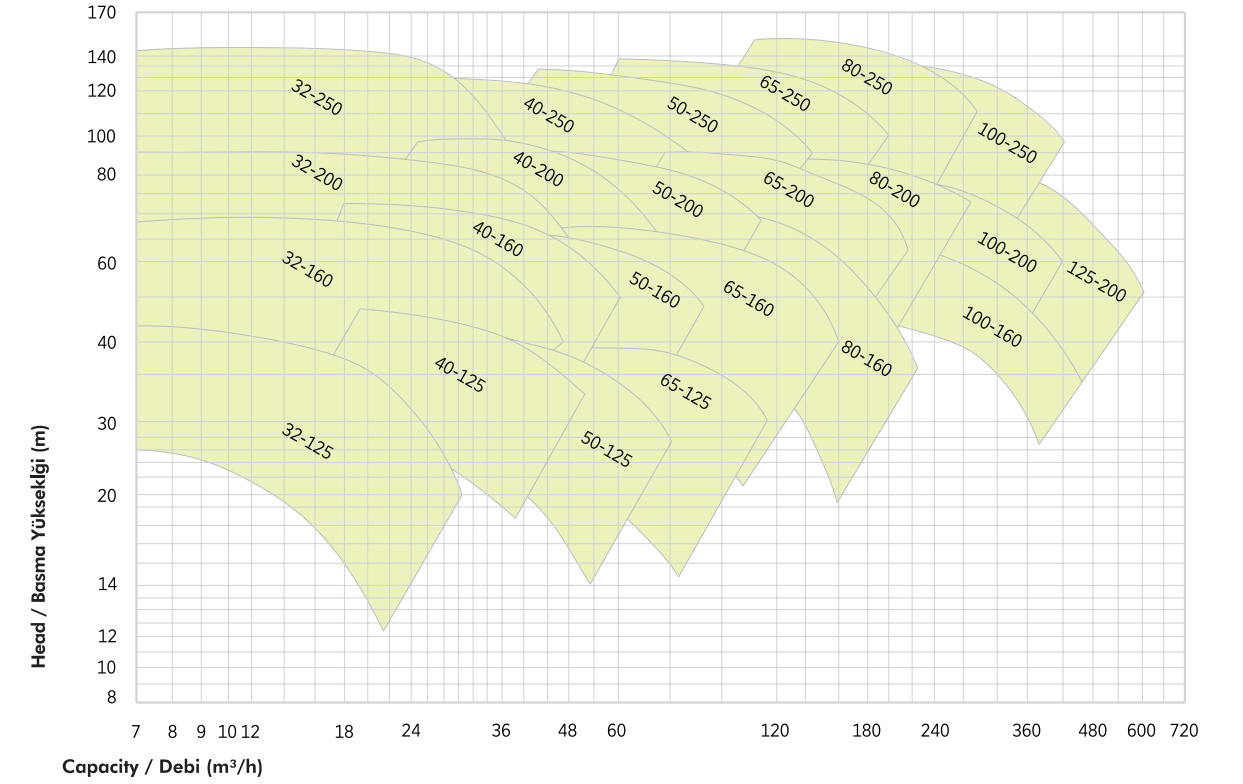

○ For detailed curves, use our selection program.

Detay eğriler için seçim programımızı kullanınız. ○

○ For detailed curves, use our selection program.

Detay eğriler için seçim programımızı kullanınız. ○

IDENTIC PART LIST

ORTAK PARÇA LİSTESİ

SECTIONAL VIEW

KESİT RESİM

Pump Type Pompa Tipi	Shaft / Mil	Mechanical Seal / Mekanik Salmastralı			Soft Packing / Yumuşak Salmastralı			
		Mechanical Seal Mekanik Salmastralı	Bearing Box Rulman Yatağı	Bearing / Rulman		Soft Packing Support Salmastralı Baskısı	Soft Packing Length Yumuşak Salmastralı Uzunluğu	Casing Support Destek Ayak
				Coupling Side Kaplın Tarafı	Impeller Side Çark Tarafı			
32-125	1 No.	MG1 30 mm	1 No.	2x6306		1 No.	8-380 mm	1 No.
32-160	1 No.	MG1 30 mm	2 No.	2x6306		1 No.	8-380 mm	2 No.
32-200	1 No.	MG1 30 mm	1 No.	2x6306		1 No.	8-380 mm	3 No.
32-250	2 No.	MG1 30 mm	2 No.	2x6306		1 No.	8-380 mm	4 No.
40-125	1 No.	MG1 30 mm	1 No.	2x6306		1 No.	8-3380 mm	1 No.
40-160	1 No.	MG1 30 mm	2 No.	2x6306		1 No.	8-380 mm	2 No.
40-200	1 No.	MG1 30 mm	1 No.	2x6306		1 No.	8-380 mm	3 No.
40-250	2 No.	MG1 30 mm	2 No.	2x6306		1 No.	8-380 mm	4 No.
40-315	3 No.	MG1 40 mm	3 No.	2x6308		2 No.	10-500 mm	7 No.
50-125	1 A No.	MG1 30 mm	1 No.	2x6306		1 No.	8-380 mm	2 No.
50-160	1 A No.	MG1 30 mm	2 No.	2x6306		1 No.	8-380 mm	3 No.
50-200	1 A No.	MG1 30 mm	1 No.	2x6306		1 No.	8-380 mm	3 No.
50-250	4 No.	MG1 30 mm	2 No.	2x6306		1 No.	8-380 mm	4 No.
50-315	5 No.	MG1 40 mm	3 No.	2x6308		2 No.	10-500 mm	8 No.
65-125	1 B No.	MG1 30 mm	1 No.	2x6306		1 No.	8-380 mm	3 No.
65-160	1 B No.	MG1 30 mm	2 No.	2x6306		1 No.	8-380 mm	3 No.
65-200	1 A No.	MG1 30 mm	1 No.	2x6306		1 No.	8-380 mm	4 No.
65-250	5 No.	MG1 40 mm	3 No.	2x6308		2 No.	10-500 mm	7 No.
65-315	5 No.	MG1 40 mm	3 No.	2x6308		2 No.	10-500 mm	8 No.
65-400	5 No.	MG1 40 mm	3 No.	2x6308		2 No.	10-500 mm	10 No.
80-160	1 A No.	MG1 30 mm	2 No.	2x6306		1 No.	8-380 mm	4 No.
80-200	5 No.	MG1 40 mm	3 No.	2x6308		2 No.	10-500 mm	6 No.
80-250	5 A No.	MG1 40 mm	3 No.	2x6308		2 No.	10-500 mm	7 No.
80-315	5 No.	MG1 40 mm	3 No.	2x6308		2 No.	10-500 mm	9A No.
80-400	6 No.	MG1 50 mm	4 No.	2x6310		3 No.	12-630 mm	9B No.
100-160	1 No.	MG1 30 mm	2 No.	2x6306		1 No.	8-380 mm	5 No.
100-200	5 No.	MG1 40 mm	3 No.	2x6308		2 No.	10-500 mm	7 No.
100-250	5 A No.	MG1 40 mm	3 No.	2x6308		2 No.	10-500 mm	8 No.
100-315	5 A No.	MG1 40 mm	3 No.	2x6308		2 No.	10-500 mm	9A No.
100-400	6 No.	MG1 50 mm	4 No.	2x6310		3 No.	12-630 mm	9B No.
125-200	5 A No.	MG1 40 mm	3 No.	2x6308		2 No.	10-500 mm	9A No.
125-250	5 A No.	MG1 40 mm	3 No.	2x6308		2 No.	10-500 mm	9A No.
125-315	6 A No.	MG1 50 mm	5 No.	2x6310		3 No.	12-630 mm	9B No.
125-400	6 No.	MG1 50 mm	4 No.	2x6310		3 No.	12-630 mm	12 No.
150-200	5 A No.	MG1 40 mm	3 No.	2x6308		2 No.	10-500 mm	11 No.
150-250	5 A No.	MG1 40 mm	3 No.	2x6308		2 No.	10-500 mm	11 No.
150-315	6 A No.	MG1 50 mm	5 No.	2x6310		3 No.	12-630 mm	9B No.
150-400	6 No.	MG1 50 mm	4 No.	2x6310		3 No.	12-630 mm	12 No.
150-500	7 No.	MG1 60 mm	6 No.	2x6312		4 No.	12-940 mm	14 No.
200-270	8 No.	MG1 50 mm	5 No.	2x6310		3 No.	12-630 mm	13 No.
200-315	9 No.	MG1 50 mm	5 No.	2x6310		3 No.	12-630 mm	13 No.
200-400	7 No.	MG1 60 mm	6 No.	2x6312		4 No.	12-940 mm	14 No.
200-500	10 No.	MG1 85 mm	7 No.	7315	NU 2315	5 No.	16-1335 mm	15 No.
250-350	10 No.	MG1 85 mm	7 No.	7315	NU 2315	5 No.	16-1335 mm	15A No.
250-400	7 No.	MG1 60 mm	6 No.	2x6312		4 No.	12-940 mm	14 No.
250-500	10 No.	MG1 85 mm	7 No.	7315	NU 2315	5 No.	16-1335 mm	15A No.

Form 1

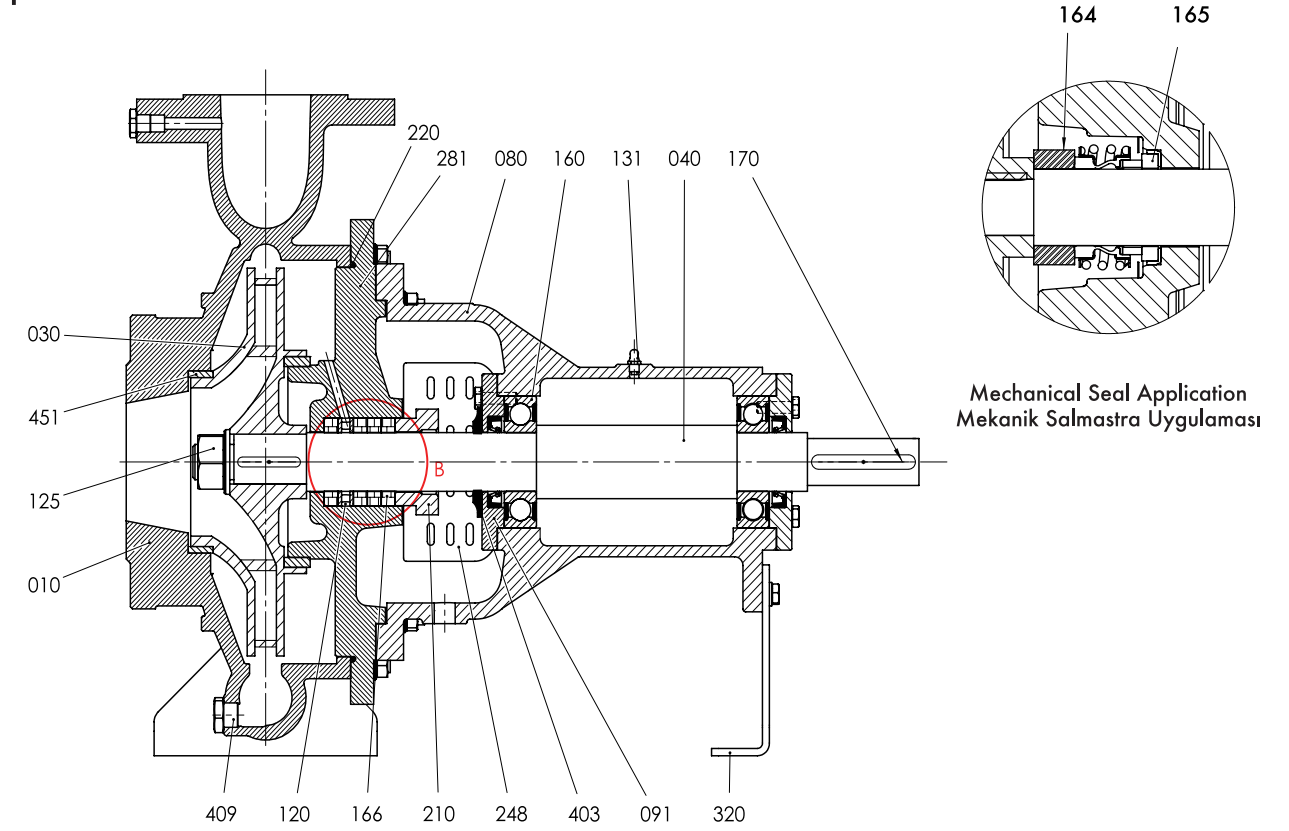

Mechanical Seal Application
Mekanik Salmastralı Uygulaması

Part List

Parça Listesi

Volute Casing	010	Salyangoz Gövde
Impeller	030	Çark
Shaft	040	Mil
Bearing Housing	080	Rulman Yatağı
Bearing Cover	091	Rulman Kapağı
Flushing Ring	120	Sulama Halkası
Nut	125	Somun
Grease Nipple	131	Gresörlük
Bearing	160	Rulman
Mechanical Seal Setting Sleeve	164	Mekanik Salmastralı Mesafe Burcu
Mechanical Seal	165	Mekanik Salmastralı
Soft Packing	166	Yumuşak Salmastralı
Key	170	Kama
Connection Support	210	Salmastralı Baskısı
O-Ring	220	O-Ring
Protection Sheet	248	Koruma Sacı
Seal Box	281	Salmastralı Kutusu
Supporting Feet	320	Destek Ayağı
Throw Protection	403	Su Sıçratma Diski
Drain Plug	409	Boşaltma Tapası
Wear Ring	451	Aşınma Halkası

SECTIONAL VIEW

Form 2

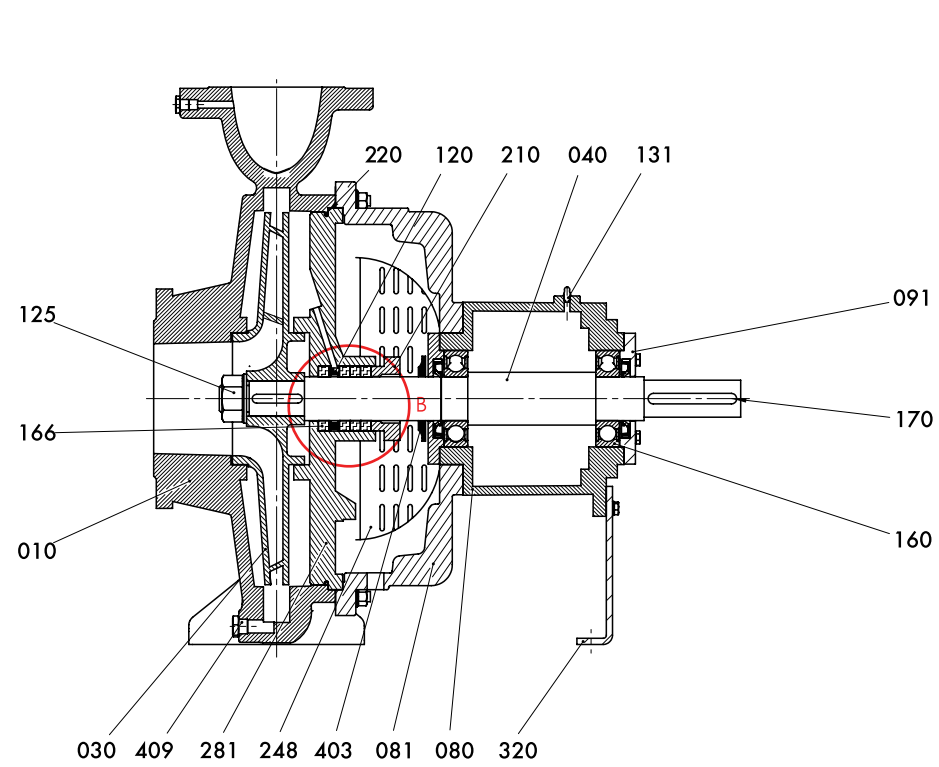

KESİT RESİM

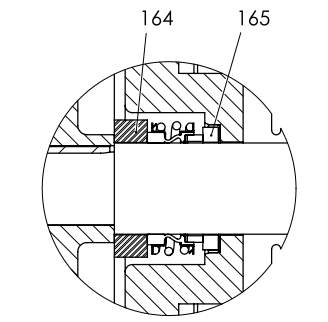

Mechanical Seal Application
Mekanik Salmastra Uygulaması

Part List

Volute Casing	010	Salyangoz Gövde
Impeller	030	Çark
Shaft	040	Mil
Bearing Housing	080	Rulman Yatağı
Interconnection Cage	081	Ara Bağlantı Kafesi
Bearing Cover	091	Rulman Kapağı
Flushing Ring	120	Sulama Halkası
Nut	125	Somun
Grease Nipple	131	Gresörlük
Bearing	160	Rulman
Mechanical Seal Setting Sleeve	164	Mekanik Salmastra Mesafe Burcu
Mechanical Seal	165	Mekanik Salmastra
Soft Packing	166	Yumuşak Salmastra
Key	170	Kama
Connection Support	210	Salmastra Baskısı
O-Ring	220	O-Ring
Protection Sheet	248	Koruma Sacı
Seal Box	281	Salmastra Kutusu
Supporting Feet	320	Destek Ayağı
Throw Protection	403	Su Sıçratma Diski
Drain Plug	409	Boşaltma Tapası

Parça Listesi

SECTIONAL VIEW

Form 3

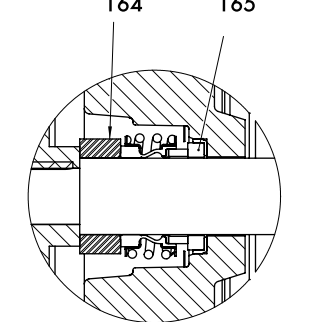
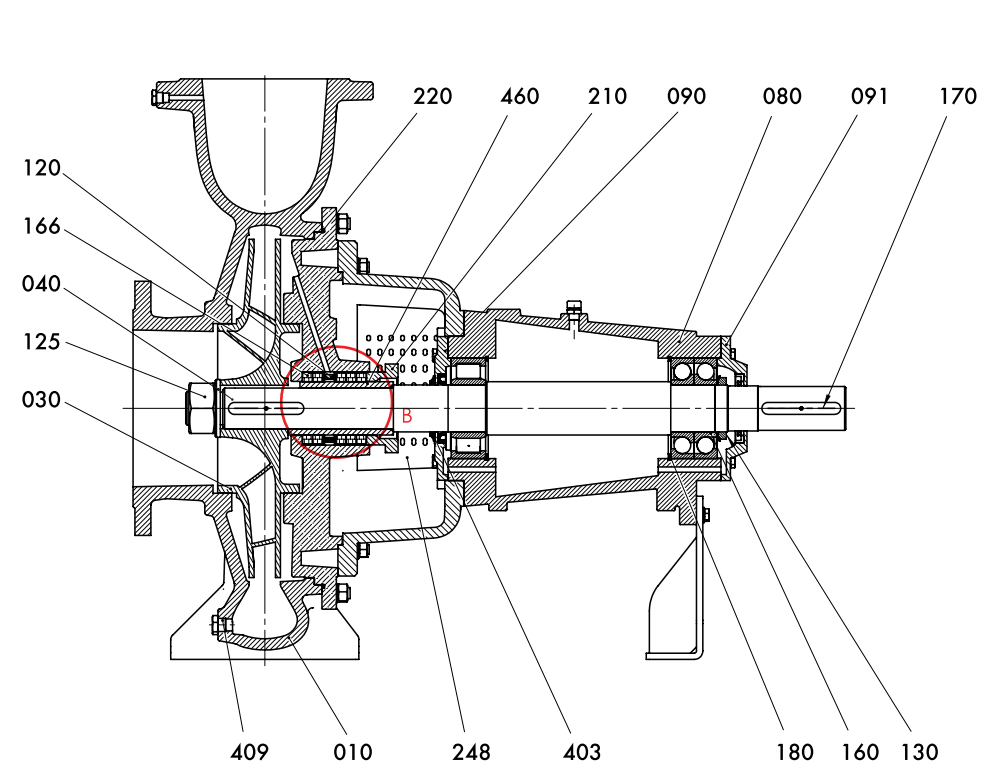

Mechanical Seal Application
Mekanik Salmastra Uygulaması

Part List

Volute Casing	010	Salyangoz Gövde
Impeller	030	Çark
Shaft	040	Mil
Bearing Housing	080	Rulman Yatağı
Bearing Cover (Inside)	090	Rulman Kapağı (iç)
Bearing Cover (Coupling)	091	Rulman Kapağı (Kaplın)
Flushing Ring	120	Sulama Halkası
Nut	125	Somun
Bearing Setting Sleeve	130	Çektirme Somun
Bearing	160	Rulman
Mechanical Seal Setting Sleeve	164	Mekanik Salmastra Mesafe Burcu
Mechanical Seal	165	Mekanik Salmastra
Soft Packing	166	Yumuşak Salmastra
Key	170	Kama
Ring	180	Segman
Connection Support	210	Salmastra Baskısı
O-Ring	220	O-Ring
Protection Sheet	248	Koruma Sacı
Throw Protection	403	Su Sıçratma Diski
Drain Plug	409	Boşaltma Tapası
Shaft Sleeve	460	Salmastra Burcu

Parça Listesi

PUMP DIMENSIONS

POMPA ÖLÇÜLERİ

PUMP DIMENSIONS

POMPA ÖLÇÜLERİ

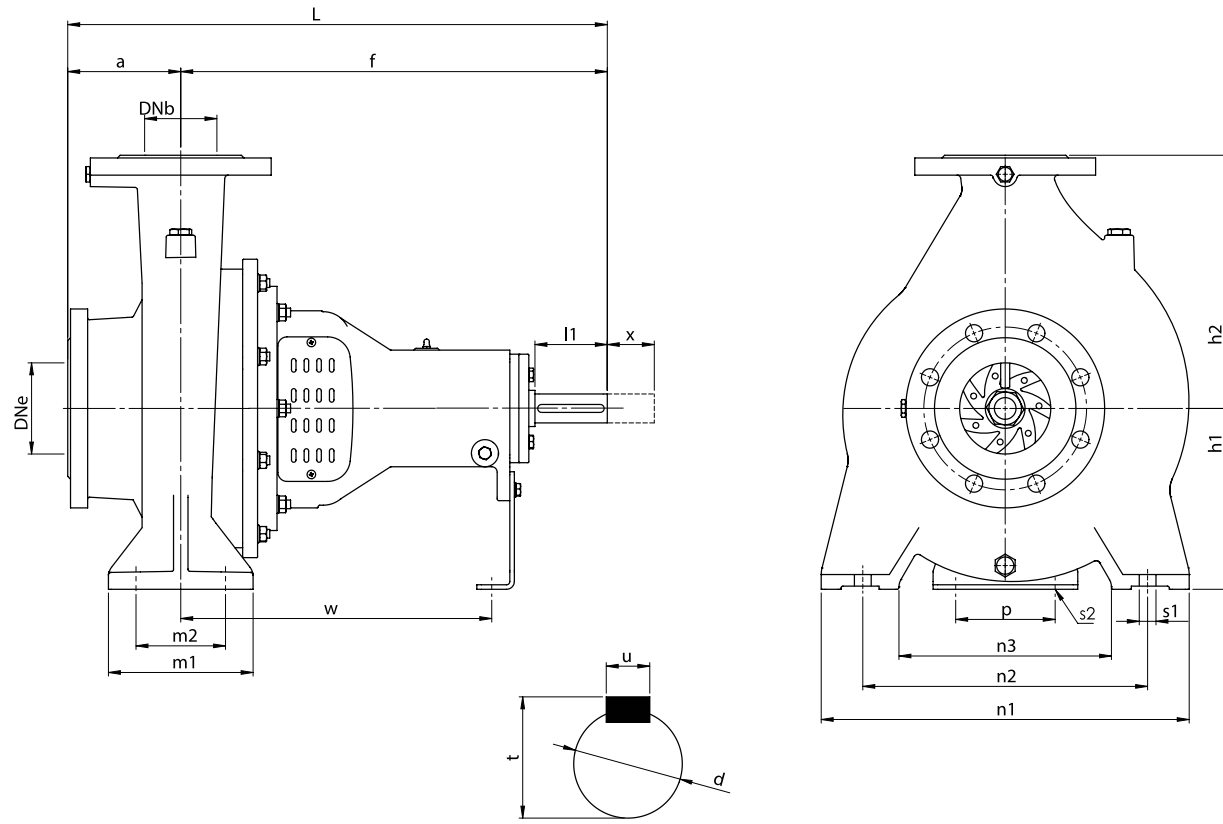

Pump Type / Pompa Tipi		Form	Dimensions / Ölçüler (mm)																			Weight Ağırlık (kg)		
EN 733	Other Diğer		Outside Dimensions / Dış Ölçüler						Supporting Foot Dimensions / Ayak Bağlantı Ölçüleri						Shaft Dimensions Mil Ölçüleri				Spacing Aralık					
		DNe	DNb	a	f	L	h1	h2	m1	m2	n1	n2	n3	s1	p	s2	w	d	l1	t	u	x		
32-125		F1	50	32	80	360	440	112	140	100	70	190	140	90	14	110	14	260	24	50	27	8	100	30
32-160		F1	50	32	80	360	440	132	160	100	70	240	190	140	14	110	14	260	24	50	27	8	100	35
32-200		F1	50	32	80	360	440	160	180	100	70	240	190	140	14	110	14	260	24	50	27	8	100	40
	32-250	F1	50	32	100	360	460	180	225	125	95	320	255	190	14	110	14	260	24	50	27	8	100	52
40-125		F1	65	40	80	360	440	112	140	100	70	210	160	110	14	110	14	260	24	50	27	8	100	31
40-160		F1	65	40	80	360	440	132	160	100	70	240	190	140	14	110	14	260	24	50	27	8	100	37
40-200		F1	65	40	100	360	460	160	180	100	70	265	212	165	14	110	14	260	24	50	27	8	100	44
40-250		F1	65	40	100	360	460	180	225	125	95	320	250	190	14	110	14	260	24	50	27	8	100	55
	40-315	F1	65	40	100	460	560	200	250	125	95	345	280	190	14	110	14	335	32	80	35	10	110	77
50-125		F1	65	50	100	360	460	132	160	100	70	240	190	140	14	110	14	260	24	50	27	8	100	35
50-160		F1	65	50	100	360	460	160	180	100	70	265	212	165	14	110	14	260	24	50	27	8	100	43
50-200		F1	65	50	100	360	460	160	200	100	70	265	212	165	14	110	14	260	24	50	27	8	100	45
50-250		F1	65	50	100	360	460	180	225	125	95	320	250	190	14	110	14	260	24	50	27	8	100	60
	50-315	F1	80	50	125	470	595	225	280	125	95	345	280	190	19	110	14	340	32	80	35	10	140	88
65-125		F1	80	65	100	360	460	160	180	125	95	280	212	150	14	110	14	260	24	50	27	8	100	38
65-160		F1	80	65	100	360	460	160	200	125	95	280	212	150	14	110	14	260	24	50	27	8	100	47
65-200		F1	80	65	100	360	460	180	225	125	95	320	250	190	14	110	14	260	24	50	27	8	140	62
65-250		F1	80	65	100	470	570	200	250	160	120	360	280	200	19	110	14	340	32	80	35	10	140	82
65-315		F1	80	65	125	470	595	225	280	160	120	400	315	240	19	110	14	340	32	80	35	10	140	97
	65-400	F1	100	65	125	470	595	260	355	160	120	435	355	275	19	110	14	340	32	80	35	10	140	118

Pump Type / Pompa Tipi		Form	Dimensions / Ölçüler (mm)																			Weight Ağırlık (kg)		
EN 733	Other Diğer		Outside Dimensions / Dış Ölçüler						Supporting Foot Dimensions / Ayak Bağlantı Ölçüleri						Shaft Dimensions Mil Ölçüleri				Spacing Aralık					
		DNe	DNb	a	f	L	h1	h2	m1	m2	n1	n2	n3	s1	p	s2	w	d	l1	t	u	x		
80-160		F1	100	80	125	360	485	180	225	125	95	320	250	190	14	110	14	260	24	50	27	8	140	51
80-200		F1	100	80	125	470	595	180	250	125	95	345	280	215	14	110	14	340	32	80	35	10	140	73
80-250		F1	100	80	125	470	595	200	280	160	120	400	315	240	19	110	14	340	32	80	35	10	140	90
80-315		F1	100	80	125	470	595	250	315	160	120	400	315	240	19	110	14	340	32	80	35	10	140	103
	80-400	F2	100	80	125	530	655	280	355	160	120	440	355	270	19	110	19	370	42	110	45	12	140	156
	80-400 EFF	F2	100	80	125	535	650	280	355	160	120	440	355	270	19	110	14	370	42	110	45	12	140	152
	100-160	F1	125	100	125	370	495	200	280	160	120	360	280	200	19	110	14	275	24	50	27	8	140	67
100-200		F1	125	100	125	470	595	200	280	160	120	360	280	200	19	110	14	340	32	80	35	10	140	82
100-250		F1	125	100	140	470	610	225	280	160	120	400	315	240	19	110	14	340	32	80	35	10	140	90
100-315		F1	125	100	140	470	610	250	315	160	120	400	315	240	19	110	14	340	32	80	35	10	140	110
100-400		F2	125	100	140	530	670	280	355	200	150	500	400	300	23	110	14	370	42	110	45	12	140	170
100-400 EFF		F2	125	100	140	530	670	280	355	200	150	500	400	300	23	110	14	370	42	110	45	12	140	175
	125-200	F1	150	125	140	470	610	250	315	160	120	400	315	240	19	110	14	340	32	80	35	10	140	100
125-250		F1	150	125	140	470	610	250	355	160	120	400	315	240	19	110	14	340	32	80	35	10	140	112
125-315		F2	150	125	140	530	670	280	355	200	150	500	400	300	23	110	14	370	42	110	45	12	140	167
125-400		F2	150	125	140	530	670	315	400	200	150	500	400	300	23	110	14	370	42	110	45	12	140	202
125-400 EFF		F2	150	125	140	530	670	315	400	200	150	500	400	300	23	110	14	370	42	110	45	12	140	195
	150-200	F1	200	150	160	470	630	280	355	200	150	505	400	300	23	110	14	340	32	80	35	10	190	135
	150-250	F1	200	150	160	470	630	280	380	200	150	510	400	300	23	110	14	340	32	80	35	10	170	148
150-315		F2	200	150	160	530	690	280	400	200	150	550	450	350	23	110	14	370	42	110	45	12	140	182
150-400		F2	200	150	160	530	690	315	450	200	150	550	450	350	23	110	14	370	42	110	45	12	140	210
150-400 EFF		F2	200	150	160	530	690	315	450	200	150	550	450	350	23	110	14	370	42	110	45	12	140	207
	150-500	F2	200	150	200	730	930	400	525	250	200	720	600	435	27	140	20	530	55	110	58	16	170	400
	200-270	F2	250	200	195	565	760	355	450	250	210	600	500	350	25	140	20	365	42	110	45	12	230	230
	200-315	F2	250	200	200	550	750	355	450	250	200	600	500	360	23	110	14	360	42	110	45	12	190	240
	200-400	F2	250	200	180	725	910	400	500	250	200	600	500	360	27	140	20	510	55	110	58	16	205	360
	200-500	F3	250	200	210	925	1135	400	525	300	240	725	600	430	27	140	20	645	70	140	73	20	255	560
	250-350	F3	300	250	255	960	1215	450	550	300	260	650	515	375	27	160	20	675	70	140	73	20	275	470
	250-400	F2	300	250	230	750	980	400	525	300	265	720	600	430	27	140	20	535	55	110	58	16	205	420
	250-500	F3	300	250	225	940	1165	450	630	300	240	725	600	400	27	160	20	655	70	140	73	20	255	670

○ x: Minimum distance between motor and pump shafts to remove rotor from rear.

○ x: Pompa rotorunu arkadan sökmek için motor ve pompa milleri arasında olması gereken minimum uzaklık.

FLANGE DIMENSIONS

FLANŞ ÖLÇÜLERİ

Pump Type Pompa Tipi	Suction & Discharge / Emme & Basma (PN 16)			
	Df	k	s	n
32	140	100	19	4
40	150	110	19	4
50	165	125	19	4
65	185	145	19	4
80	200	160	19	8
100	220	180	19	8
125	250	210	19	8
150	285	240	23	8
200	340	295	23	12
250	405	355	28	12
300	460	410	28	12

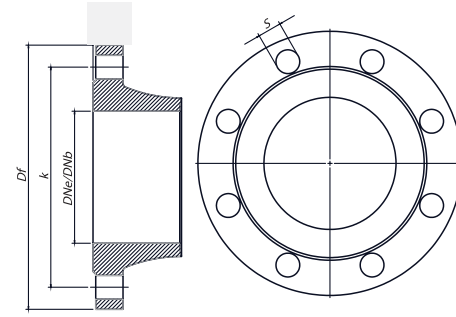

○ TS EN 1092-2 ○ "n" Number of Holes / Delik Sayısı



SEAL SOLUTIONS

SALMASTRA ÇÖZÜMLERİ

Packing Type / Salmastra Tipi	Packing Specifications / Salmastra Özellikleri	
	Temperature / Sıcaklık	Pressure / Basınç
MG1	t = -20 °C ... +85 °C t = +85 °C ... +100 °C (*)	p1 = 16 bar (230 PSI) p1 = 16 bar (230 PSI) (*)
H12N	t = +100 °C ... +140 °C	p1 = 25 bar (363 PSI)
M7N	t = -20 °C ... +220 °C	p1 = 25 bar (363 PSI)
Soft Packing / Yumuşak Salmastra	t = -20 °C ... +100 °C	p1 = 10 bar (145 PSI)
	t = -20 °C ... +140 °C (*)	p1 = 25 bar (230 PSI) (*)
CARTEX - DN	t = -20 °C ... +220 °C	p1 = 25 bar (363 PSI)

○ (*) Optional

*Note: Above datas mentioned according to BURGMANN Brand.
Packing can be changed according to customer request.

*Different seal application can be used according to liquid
specification.

○ (*) Opsiyonel

*Not: BURGMANN marka mekanik salmastraya göre belirlenmiştir.
Müşteri isteğine göre salmastra marka değişikliği yapılabilir.

*Akışkan cinsi ve çalışma şartlarına göre farklı salmastra seçenekleri
uygulanabilir.

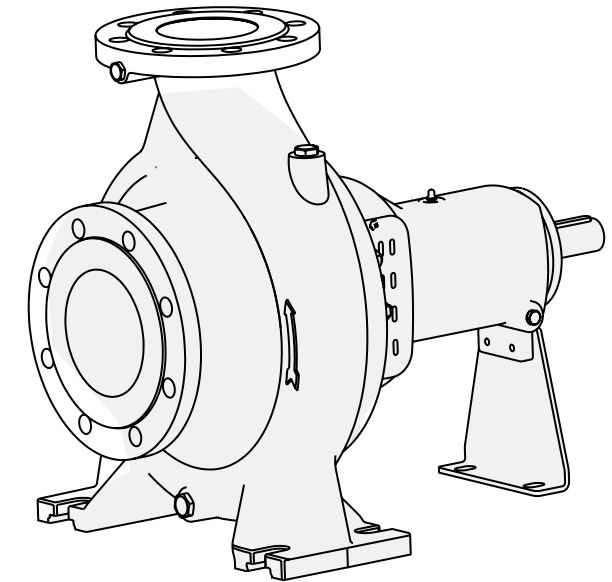



arian®
PUMPS
Technology and quality

Head Office:

Arian Pumps Makina San. ve Tic.
Perpa Ticaret Merkezi A Blok Kat: 12
No: 1765 Okmeydanı - Şişli / ISTANBUL / TURKEY
Tel : +90 212 222 41 66 (Pbx)

 **+90 533 304 39 57**

export@arianpumps.com - www.arianpumps.com - info@arianpumps.com